

MHXFWCA

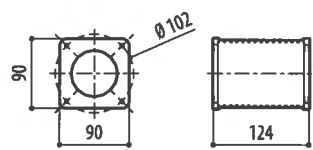

NXFWBT

TECHNICAL DRAWINGS

The indicated measurements are expressed in millimetres.

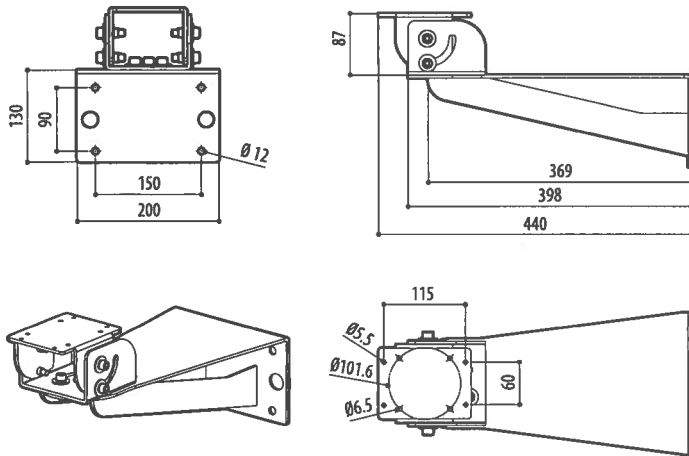

MHXWBS

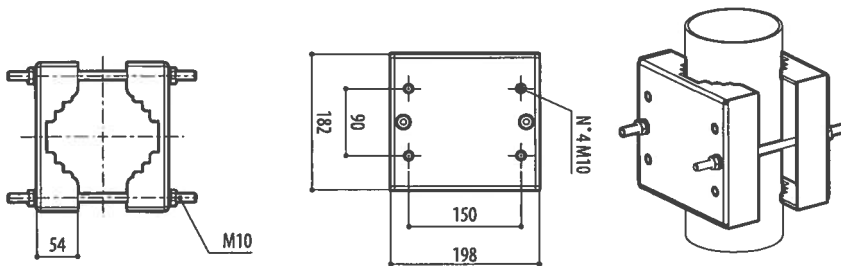

MPXCOL

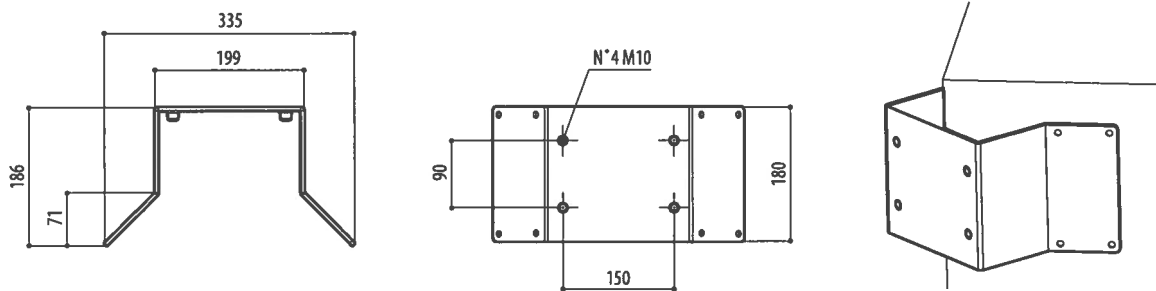

MPXCW

TECHNICAL DATA

MHXWBS

MECHANICAL

Bracket for MHX, MHXT, NXM, NXM36, NXM36 Hi-PoE, NXW, NTW, NTM

Suitable for MPXCOL, MPXCW

Made of AISI 316L electropolished stainless steel

Load rating: 40kg (88lb)

Length: 440mm (17.3in)

Unit weight: 5.4kg (11.9lb)

PART NUMBER

MHXWBS AISI 316L stainless steel wall bracket

PACKAGE

Model Number	Weight	Dimensions (WxHxD)	Master carton
MHXWBS	6.5kg (14.3lb)	58x34x22cm (23x13.4x8.7in)	-

MPXCOL

MECHANICAL

Suitable for MHXWBS

Suitable for MPXWBA

Made of AISI 316L electropolished stainless steel

For pole diameters: 110-150mm (4.3-5.9in)

Load rating: 50kg (110lb)

Unit weight: 4.5kg (9.9lb)

PART NUMBER

MPXCOL AISI 316L stainless steel pole adapter module

PACKAGE

Model Number	Weight	Dimensions (WxHxD)	Master carton
MPXCOL	4.9kg (10.8lb)	24x15x21.5cm (9.4x6x8.5in)	6

MPXCW

MECHANICAL

Suitable for MPXWBA

Suitable for MHXWBS

Made of AISI 316L electropolished stainless steel

Load rating: 50kg (110lb)

Dimensions: 335x186mm (13.2x7.3in)

Unit weight: 3.6kg (7.9lb)

PART NUMBER

MPXCW AISI 316L stainless steel corner adapter module

PACKAGE

Model Number	Weight	Dimensions (WxHxD)	Master carton
MPXCW	4.8kg (10.6lb)	36.5x25.5x26cm (14.4x10x10.2in)	5

MHXWFWCA

MECHANICAL

Ball joint for housings: MVX, MVXT, MVXHD, MHX, MHXT, NXM, NXM36, NXM36 Hi-PoE, NXW, NTW, NTM

Suitable for: NXFWBT

Made of AISI 316L electropolished stainless steel

Load rating: 40kg (88lb)

Dimensions: Ø 101.6mm (4in)

Unit weight: 2kg (4.4lb)

PART NUMBER

MHXWFWCA AISI316L stainless steel ball joint

PACKAGE

Model Number	Weight	Dimensions (WxHxD)	Master carton
MHXWFWCA	2.5kg (5.5lb)	19x19x19 cm (7.5x7.5x7.5in)	-

NXFWBT

MECHANICAL

Suitable for: MHXWFWCA

Suitable to MVX housings only if coupled with MHXWFWCA joint

Suitable for NXWBPTH1

Made of AISI 316L electropolished stainless steel

Load rating: 70kg (154lb)

Height: 124mm (4.9in)

Unit weight: 0.9kg (2lb)

PART NUMBER

NXFWBT AISI 316L stainless steel parapet mounting bracket

PACKAGE

Model Number	Weight	Dimensions (WxHxD)	Master carton
NXFWBT	1kg (2.2lb)	10x16x23cm (4x6x9in)	-

MAXIMUS MHX RANGE, BRACKETS



MHXWBS

WALL MOUNT BRACKET

Made of AISI 316L electropolished stainless steel

Load rating: 40kg (88lb)

Length: 440mm (17.3in)

Suitable for: MPXCW, MPXCOL



MHXWBS

MPXCOL

POLE MOUNT ADAPTOR

Made of AISI 316L electropolished stainless steel

For pole diameters: from 110mm (4.3in) up to 150mm (5.9in)

Load rating: 50kg (110lb)

Dimensions: 198x182mm (7.8x7.2in)

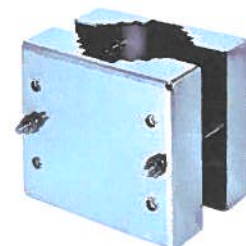

MPXCOL

MPXCW

CORNER MOUNT ADAPTOR

Made of AISI 316L electropolished stainless steel

Load rating: 50kg (110lb)

Dimensions: 335x186mm (13.2x7.3in)

Suitable for: MPXWBA, MHXWBS

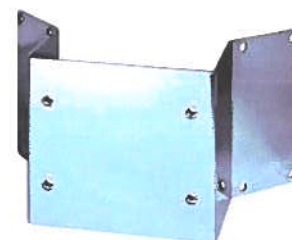

MPXCW

MHXFWCA

PARAPET MOUNTING BRACKET

Made of AISI 316L electropolished stainless steel

Load rating: 40kg (88lb)

Dimensions: Ø 101.6mm (4in)

Compatible with the bracket: NXFWBT

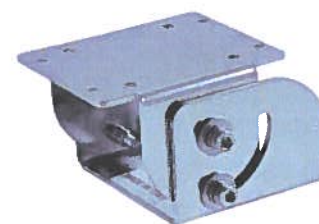

MHXFWCA

NXFWBT

EXTENSION BRACKET FOR PARAPET MOUNTING

Suitable for MHXFWCA ball joint

Suitable to MVX housings only if coupled with MHXFWCA joint

Made of AISI 316L electropolished stainless steel

Load rating: 70kg (154lb)

Height: 124mm (4.9in)

Suitable for: NXWBPTH1



NXFWBT