

# AVerMedia

AVerDiGi EH5116 Pro 16CH Embedded Hybrid



## THE FIRST FULL FUNCTIONAL EMBEDDED HYBRID DVR IN THE WORLD

AVerDiGi EH5116 Pro adopts embedded Linux operation system to come out the first embedded hybrid DVR within universal surveillance market. Such pioneer design enables users to control preview and playback just right on server site to protect safety efficiently. EH5116 Pro also has new graphic user interface (GUI) to replace traditional OSD user interface and supports up to 240fps at D1 resolution to deliver the best image quality for customers.

### ► Key Features

- Embedded Linux
- 16CH IP and Analog camera inputs
- Recording 240fps (IP) or 120fps (Analog) at D1 resolution
- Individually adjust channel frame rate and resolution **NEW**
- Supports all major brands of IP cameras within the industry
- Supports up to 5 Megapixel IP cameras and IP PTZ
- Instinctive and user-friendly Graphic User Interface (GUI) **NEW**
- Local/server site preview and playback from DVR directly
- Multi-operation interface: mouse, keyboard, remote control, front panel, and remote setup
- Supports 1CH VGA output
- Multi-functional LCM display
- Supports up to 1 removable and 3 internal SATA HDD (storage space up to 4TB)
- Support Gigabyte LAN to ensure network connection speed
- Supports 16 sensors in / 4 relays out
- On-line live update for function upgrade
- Supports AVerDiGi RA4000e (optional)



Individually adjust channel frame rate and resolution & GUI

## Application Diagram

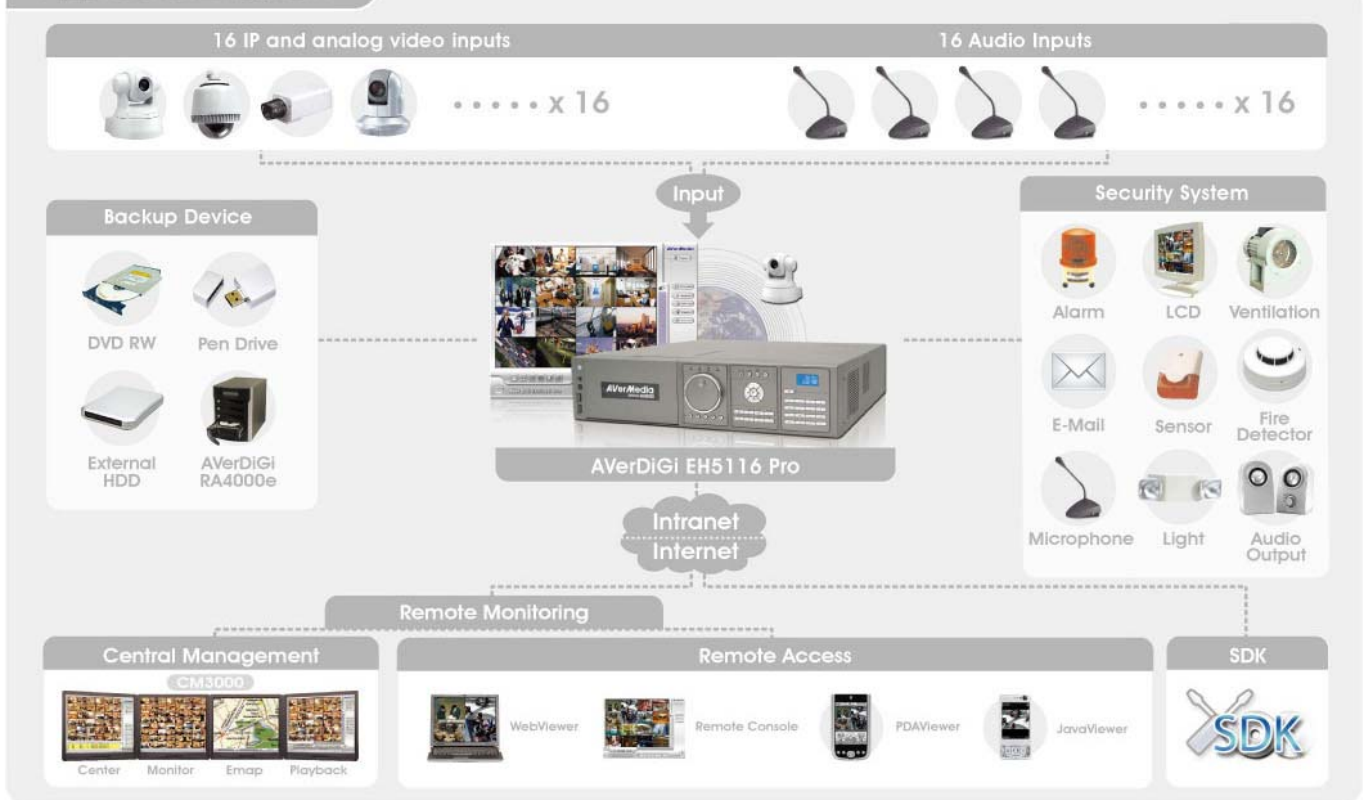

## Product Illustration

### Front

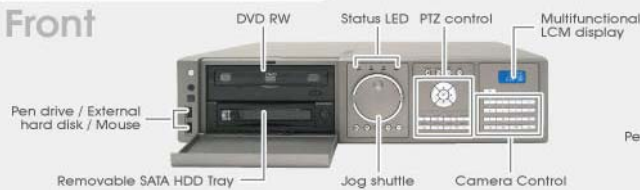

### Rear

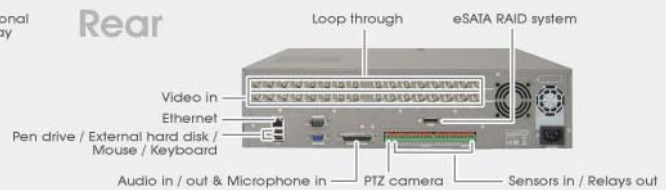

## Product Features

Product Name	EH5116 Pro
Video Streaming format	MJPEG, MPEG4
Video Input	16CH IP or analog Inputs
Audio Input	16CH audio in / 1CH MIC in
IP Display Rate	120 / 100fps at D1 resolution
IP Recording Rate	240 / 200fps at D1 resolution
Analog Display Rate	Real-time display
Analog Recording Rate	120/100fps at D1 resolution
IP Recording Resolution	Up to 2592 x 1944 (5 Megapixel)
Playback Mode	Continuous / Motion / schedule (weekly based)
Sensor / Relay	16/4
Audio Out	1
VGA Out	1
Operation Interface	Mouse, Keyboard, Remote control, Front panel, Remote setup
Backup Device	DVD RW / USB2.0
Number of HDDs supported	4 (3 internal SATA HDDs and 1 removable SATA HDD)
LCM Display	Temperature, System status
Support major brands of IP cameras	AXIS, SONY, Panasonic, Samsung, Sanyo, Arecont, Lumenera, Mobotix, BOSCH, IQinvision, JVC, TOSHIBA, VIVOTEK, ACTI, Dynacolor, Yoko, Hunt, D-Link, PIXORD, PELCO, Apron, Lilin, Linksys, Level-one, ZAVIO, and more
Connector	RS232 x 1, USB x 4 RJ-45:10 / 100 / 1000 Mbps
Remote Access	CM3000, Remote Console, WebViewer, PDAViewer, JavaViewer,
Video Enhancer Software	IEEnhance / IStable
Optional Device	Rack ears (For easy and efficient installation) AVerDiGi RA4000e (Up to 2TB storage capacity with 500GB / 750GB / 1TB disks)



All right reserved. No part of this document may be reproduced, stored in a retrieval system, or transmitted in any form or by any means (Electronic, mechanical, photocopying, recording, or otherwise) without the written permission of AVerMedia INFORMATION, Inc. Information in this document is subject to change without notice. The information contained herein, is to be considered for informational purposes only and shall not be considered legally binding. 2008 by AVerMedia INFORMATION, Inc. All rights reserved. No part of this publication may be reproduced, transmitted, transcribed, stored in a retrieval system, or translated into any language in any form by any means without the written permission of AVerMedia INFORMATION, Inc. AVerMedia is registered trademarks of AVerMedia INFORMATION, Inc. All other trademarks belong to their respective companies. Made in Taiwan.20090418

**AVerMedia**<sup>®</sup>  
www.avermedia.com  
www.averdigi.com