

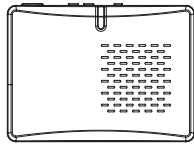

iVISION+

Wireless Video Intercom



IVP-GU(G) (Gateway Chime Unit) Installation Instructions



ATTENTION:

Thank you for purchasing the iVISION+ wireless video intercom. Before installation and usage, please read this instruction manual thoroughly and keep this safe for future reference.

IVP-GU(G) features

- "OPEN DOOR" Relay Output Function
- AC/DC (10~24V) Adaptable
- Chime On-Off Mode

* Relay Output function must meet other requirements dependent on the third party equipment. OPTEX will not be held responsible for any damage or injuries caused due to using this function.

1. IMPORTANT NOTICE

Operations under harsh environments such as out of warranted temperature, rapid temperature change, high humidity, constant moisturization may cause the unit to malfunction.

Electronic device such as TVs, Radios, PCs, Microwave ovens or any other device with an electric motor may cause the unit to malfunction.

Impact or shocks can cause severe damage to the unit. Please handle the unit with care and operate without exerting strong forces.

Transmission range of communication between units may decrease under the following conditions.

- Any unit is installed on a metal surface.
- Presence of reinforced concrete, steel doors or other metal construction materials between units.
- Places near strong radio sources such as broadcast stations or substations.

While installing/using a Gateway Chime Unit

- Do not install/use in damp, steamy or dusty environments.
- Do not hold the Gateway Chime Unit to your ear - your hearing could be damaged.
- Do not install in an unstable location or where subject to strong vibration.

2. CHOOSING LOCATION

If there is a pre-existing door bell inside the house, a Gateway Chime Unit (IVP-GU) may be capable of adapting the pre-existing power wires (AC/DC 10-24V 3 Wmax).

IVP-GU should be located in a place where the unit has a clear signal reception and transmission availability.

The performance of a IVP-GU is dependent on the transmission environment of radio signals from locations of connecting units. A communication range will be significantly reduced by more number and thickness of walls which the signal is required to pass.

For iVISION+ system, maximum communication range is around 300ft (100m) in an open air environment. Following materials may decrease the maximum communication range and may potentially cause loss of transmission signals.

- Metal barricades such as metal doors and shutters.
- Walls with aluminium foil insulation.
- Concrete or galvanized metal walls.

Gateway Chime Unit uses 2.4GHz radio frequency for iVISION+ system.

3. PARTS IDENTIFICATION

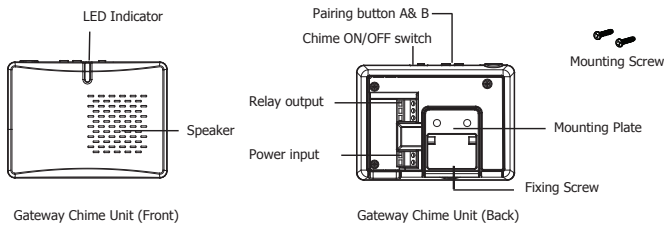

4. POWERING THE UNIT

The Gateway Chime Unit needs to be powered from an AC/DC 10-24V 3W(max) power source. An open ended third party power adapter may be available from local electronics stores. Power input has no polarity. Please make sure to tighten terminal screws to avoid loose ends.

If applicable, configure all pairing setup and carry out feasibility study before mounting on a wall.

5. INSTALLATION

One iVISION+ system can host up to 2 units of Gateway Chime Unit (IVP-GU).

If "OPEN DOOR" Relay Output function is used, please carefully choose a location for each of IVP-GU to secure a physical access to the IVP-GU.

For the optimal radio performance, mount IVP-GUs high on a wall and in an open area avoiding a metal surface and surrounding.

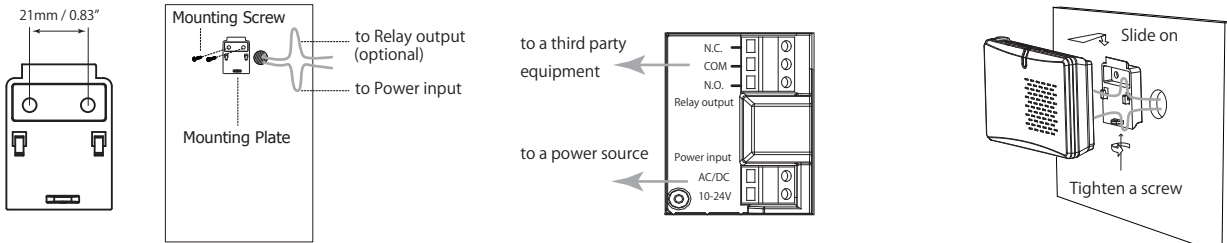

(1) Fix a Mounting Plate on a feasible location

(2) Run a power cable to the location and connect to the Power input. If applicable, also run a relay connection from the Relay output to the third party equipment.

(3) Slide the IVP-GU onto the Mounting Plate and tighten the Fixing Screw at the bottom.

6. PAIRING WITH OTHER iVISION+ DEVICES

One iVISION+ system can host up to 2 units of Gateway Chime Unit (IVP-GU).

NOTE: One Handheld Monitor Unit (IVP-HU) must be configured to have a HOME ID*1 prior to pairing up with other iVISION+ devices. For setting up a new HOME ID, please refer to the Installation Instructions of IVP-HU. A Handheld Monitor Unit bundled with Door Camera Unit (IVP-DU) already has a HOME ID set up and paired up to each other.

While the IVP-GU is in a factory default setting, the unit has not been assigned to a HOME ID. When powering the unit, green and red LED will flash with beep sound to indicate its pairing mode. Please proceed to (2). (... continues onto the other side)

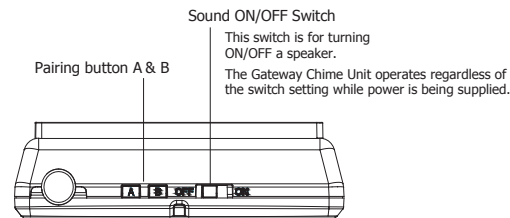

*1 HOME ID is a unique identification number for your iVISION+ system.

(1) Entering Pairing mode of a Gateway Chime Unit (IVP-GU).

An IVP-GU is already set in a "Pairing mode" at the factory default setting. To change IVP-GU into the "Pairing mode", press down both A and B buttons and hold until LED will blink in green and red.

(2) Prepare Handheld Monitor Unit (IVP-HU) for assigning a HOME ID for IVP-GU. Press "Pairing Button" on the back of an IVP-HU and choose "SCAN" by clicking "left function key" on the IVP-HU. The IVP-HU starts scanning for a new device.

(3) Confirming IVP-GU with a HOME ID.

When IVP-GU is assigned a new HOME ID, beeping stops and LED stops flashing to indicate the normal operation mode.

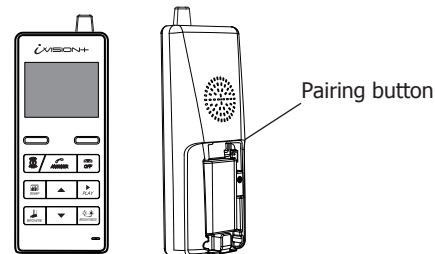

Handheld Monitor Unit (IVP-HU)

7. ADDITIONAL SETTING

To change a chime volume of IVP-GU

- Press button A to acknowledge current chime volume level. Press A button again to change volume level to the next. The volume changes within 4 levels and the lowest volume will follow the loudest. Leave the setting at the desirable volume level. To completely turn off the chime, set Sound ON/OFF Switch to OFF.

8. SPECIFICATION

8-1 Dimensions

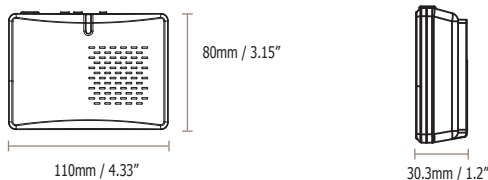

8-2 Specification Table

MODEL NAME: OPTEX iVISION+ (IVP-GU) Gateway Chime Unit

Operating Temperature	0 to 40 degC (32 to 104 degF)
Operating Humidity	< 90% RH (no condensation)
Dust/Water Protection	N/A (Indoor Use Only)
Radiowave Frequency	2.4 GHz and 418MHz
Power	AC/DC 10-24V 3W(max)
Relay Output	1C 50VAC/24VDC 1A max

9. WARRANTY

1. This product is under a warranty for a normal usage for 18 months from the date of manufacturing. The date of manufacturing can be identified from a LOT number indicated on a label placed in a back of IVP-GU.

LOT: YYWWZ (e.g. LOT 1350Z)

YY indicates last two digits of the year manufactured (e.g. "13" = Year 2013)
 WW indicates Xth week of the year manufactured (e.g. "50" = 50th week)

2. The warranty may **not be applicable** when any of following circumstances is found.

- Mechanical or electrical modification is made to the product and the good's appearance indicates an alterations or a significant damage.
- The product is already been diagnosed by someone other than the manufacturer.
- Product malfunction is resulting from an improper usage, an accident, natural disaster or any environmental event.
- Please call our technical assistance before arranging a return.



OPTEX CO., LTD. (JAPAN)

URL: <http://www.optex.net/>

OPTEX INC. (U.S.)

URL: <http://www.optexamerica.com/>

OPTEX DO BRASIL LTDA. (Brazil)

URL: <http://www.optex.net/br/es/sec/>

OPTEX (EUROPE) LTD. / EMEA HQ (U.K.)

URL: <http://www.optexeurope.com/>