

2 push button panel  
Posto esterno a 2 pulsanti



Flush  
Incasso



Surface  
Superficie

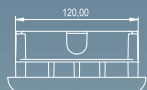

DK4K-1S



### DK4K SERIES DIGIPHONE KIT

As 4K1 audio kit with the addition of a VIDEX codelock module Art.4800. This additional feature allows the user to open the door from outside by typing the relevant access code into the keypad.

#### DK4K-1

One button door entry kit comprised of:

**1 Outdoor station** including a one button speaker module Art.4836-1, a digital codelock Art.4800 Codelock module, (3 codes / 3 relay outputs with keypad illumination) and a flush mounting box with module support and hinge Art.4852. Standard finishes: mirror stainless steel for the front plate and gun metal grey for the module support.

**1 Art.3011** 3000 Series Smart Line wall mount telephone with "door open" push button and electronic call tone with 3 level adjustable volume control.

**1 Art.321** Power Supply in a type A 3 module DIN box.

Packing: cardboard 30.5x29x7cm total weight Kg.2.4

#### DK4K-2

As DK4K-1 but two button version with 2 call button speaker unit Art.4836-2 and 2 intercoms.

Packing: cardboard 41x29x7cm total weight Kg.2.7

#### DK4K-1S, DK4K-2S

As kits above but with surface mounting box Art.4882.

Packing: the same as the relevant flush mount version but with total weight 2.8 Kg for one button version and 3.1 Kg for 2 button version.

The module support frame and the module front plate are available in other finishes, **see pictures 4 and 5 on page 33** for available versions and additional suffix to use for orders.

